

SAMSUNG

**Washing Machine
Owner's Instructions**

SW1050



Congratulations on your purchase of this Samsung washing machine. These Owner's Instructions contain valuable information on the installation, use, and care of this appliance. Please take the time to read these instructions so that you can take full advantage of the washing machine's features and enjoy this appliance for many years to come.

Before using the appliance

- Packing materials can be dangerous to children; keep all packing material (plastic bags, polystyrene, etc.) well out of the reach of children.
- The appliance is designed for home use only.
- Make sure that water and electrical connections are made by qualified technicians, observing the manufacturer's instructions (see "Installing the Washing Machine" on page 2) and local safety regulations.
- All packaging and shipping bolts must be removed before the appliance is used. Serious damage may occur if they are not removed. See "Removing the shipping bolts" on page 3.
- Before washing clothes for the first time, you must run a complete cycle without clothes. See "Washing for the first time" on page 8.

Safety instructions

- Before cleaning or carrying out maintenance, unplug the appliance from the electrical outlet or set the **⓪ (On/Off)** button to **Off**.
- Make sure that the pockets of all clothing to be washed are empty. Hard, sharp objects, such as coins, safety pins, nails, screws, or stones can cause extensive damage to the appliance.
- Always unplug the appliance and turn off the water after use.
- Before you open the door of the appliance, check that the water has drained. Do not open the door if you can still see water.
- Pets and small children may climb into the appliance. Check the appliance before each use.
- The glass door becomes very hot during the washing cycle. Keep children away from the appliance while it is in use.
- Do not attempt to repair the appliance yourself. Repairs made by inexperienced or unqualified persons may cause injury and/or make more serious repairs to the appliance necessary.
- If the plug (power supply cord) is damaged, it must be replaced by the manufacturer or its service agent or a similar qualified person in order to avoid a hazard.
- This appliance should only be serviced by an authorized service center, and only genuine spare parts should be used.

Safety Precautions	inside cover
Installing the Washing Machine	2
Unpacking the washing machine	2
Overview of the washing machine	2
Selecting a location	3
Adjusting the leveling feet	3
Removing the shipping bolts	3
Connecting the water supply hose	3
Positioning the drain hose	4
Plugging in the machine	5
Washing a Load of Laundry	6
Overview of the control panel	6
Washing for the first time	8
Putting detergent in the washing machine	8
Operating Instruction	9
When the cycle is finished	9
Washing tips and hints	10
Maintaining the Washing Machine	11
Draining the washing machine in an emergency	11
Repairing a frozen washing machine	11
Cleaning the exterior	11
Cleaning the detergent drawer and recess	11
Cleaning the debris filter	12
Cleaning the water hose mesh filter	12
Troubleshooting	13
Problems and solutions	13
Understanding error messages	13
Programme chart	14
Appendix	15
Fabric care chart	15
Electrical warnings	15
Protecting the environment	16
Declaration of conformity	16
Specification	16

Installing the Washing Machine

Unpacking the Washing Machine

Unpack your washing machine and inspect it for shipping damage. Also make sure that you have received all of the items shown below. If the washing machine was damaged during shipping or you do not have all of the items, contact your Samsung dealer immediately.

Overview of the washing machine

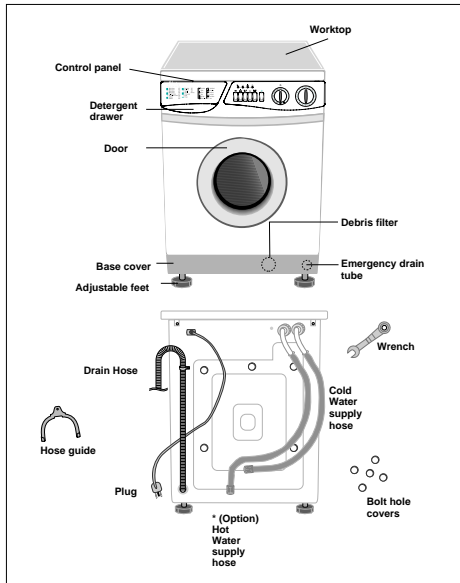

Installing the Washing Machine

Selecting a location

Before you install the washing machine, select a location with the following characteristics:

- A hard, level surface (if the surface is uneven, see "Adjusting the leveling feet," below)
- Away from direct sunlight.
- Adequate ventilation
- Room temperature that will not fall below 0 °C
- Away from sources of heat such as coal or gas

Make sure that the washing machine does not stand on its power cord.

Ventilation openings must not be obstructed by carpeting when the washing machine is installed on a carpeted floor.

Adjusting the leveling feet

If the floor is uneven, adjust the feet (do not insert pieces of wood or any other objects under the feet):

1. Loosen the leg bolt by turning it with your hand until it is at the desired height.
2. Tighten the locking nut by turning it with the supplied wrench.



Place the washer on a sturdy, flat surface.

If the washer is placed on an uneven or weak surface, noise or vibration occurs. (Only a 1 degree angle is allowed.)

Removing the shipping bolts

Before using the washing machine, you must remove the five shipping bolts from the back of the unit. To remove the bolts:

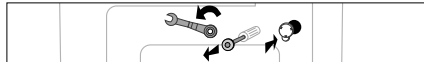

1. Loosen all bolts with the supplied wrench before removing them.
2. Take each bolt head and pull it through the wide part of the hole. Repeat for each bolt.
3. Fill the holes with the supplied plastic covers.
4. Keep the shipping bolts for future use.

Connecting the water supply hose (Option)

1. Remove the adaptor from the water supply hose.
 
 2. First, using a "+" type screw driver, loosen the four screws on the adaptor. Next, take the adaptor and turn part(b) following the arrow until there is a 3mm gap.
 
 3. Connect adaptor to the water tap by tightening the screws firmly. Then, turn part (b) following the arrow and part(a) and (b) together.
 
 4. Connect the water supply hose to the adaptor. Pull down part (c) of the water supply hose. When you release part (c) the hose automatically connects to the adaptor making a "click" sound.
 
 5. Connect the other end of the water supply hose to the inlet water valve at the top of the washer. Screw the hose clockwise all the way in.
 
- If the water tap has a screw type faucet, connect the water supply hose to the tap as shown.
 

NOTICE After completing connection, if water leaks from the hose, then repeat the same steps. Use the most conventional type of faucet for water supply. In case the faucet is square or too big, remove the spacing ring before inserting the faucet into the adaptor.

Installing the Washing Machine

Connecting the water supply hose

The water supply hose must be connected to the washing machine at one end and to the water faucet at the other. Do not stretch the water supply hose. If the hose is too short and you do not wish to move the water faucet, replace the hose with a longer, high pressure hose.

To connect the water supply hose:

1. Take the L-shaped arm fitting for the cold water supply hose and connect to the cold water supply intake on the back of the machine. Tighten by hand.

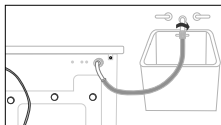

2. Connect the other end of the cold water supply hose to your sink's cold water faucet and tighten it by hand. If necessary, you can reposition the water supply hose at the washing machine end by loosening the fitting, rotating the hose, and retightening the fitting.

Option: 1. Take the red L-shaped arm fitting for the hot water supply hose and connect to the red hot water supply intake on the back of the machine. Tighten by hand.

2. Connect the other end of the hot water supply hose to your sink's hot water faucet and tighten it by hand.

3. Use a Y-piece if you only want to use cold water.

Positioning the drain hose

The end of the drain hose may be positioned in three ways:

Over the edge of a sink

The drain hose must be placed at a height of between 60 and 90 cm. To keep the drain hose spout bent, use the supplied plastic hose guide. Secure the guide to the wall with a hook or to the faucet with a piece of string to prevent the drain hose from moving.

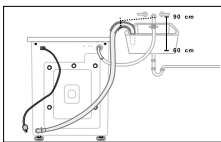

In a sink drain pipe branch

The drain pipe branch must be above the sink siphon so that the end of the hose is at least 60 cm above the ground.

In a drain pipe

Samsung recommends that you use a 65 cm high vertical pipe; it must be no shorter than 60 cm and no longer than 90 cm.

Installing the Washing Machine

Plugging in the machine

For European Users. You will **NOT** need to ground the plug of the washing machine.

For U.S. Users. You **MUST** ground the plug of the washing machine.

Check with a licensed electrician before using the machine to make sure it is properly grounded.

For U.K. Users.

Wiring Instructions

WARNING THIS APPLIANCE MUST BE EARTHED.

This appliance must be earthed. In the event of an electrical short circuit, earthing reduces the risk of electric shock providing an escape wire for the electric current. The appliance is equipped with a mains lead which includes an earth wire for connecting to the earth terminal of your mains plug. The plug must be plugged into a socket that is properly installed and earthed.

*The wires in this mains lead are coloured in accordance with the following code:

- Green and yellow : Earth
- Blue : Neutral
- Brown : Live

- AS the colours of the wires in the mains lead of this appliance may not correspond with the coloured markings identifying the terminals in your plug, proceed as follows.

- Connect the green and yellow wire to the terminal in the plug marked with the letter E or the earth symbol (⏏) or coloured green or green-and-yellow.
- Connect the blue wire to the terminal marked with the letter N or coloured black.
- Connect the brown wire to the terminal marked with the letter L or coloured red.
- Consult a qualified electrician or service technician if in doubt about any of these instructions.

The manufacturer of this washing machine will not accept any liability for damage to persons or material for non observance of these requirements. There are no **user serviceable** parts inside the washing machine and if the mains lead of this appliance is damaged, it must only be replaced by qualified service personnel approved by the manufacturer because special tools are required.

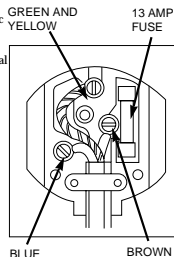

WARNING

Ensure that the plug and power cord are not damaged before use. If you have any reason to remove the moulded plug from this appliance, immediately remove the fuse and dispose of the plug. Do not connect the plug to a mains socket under any circumstances as there is a danger of electric shock.

CIRCUITS

Your washing machine should be operated on a separate circuit from other appliances. Failure to do this may cause the circuit breaker to trip or the fuse to blow.

Washing a Load of Laundry

Overview of the control panel

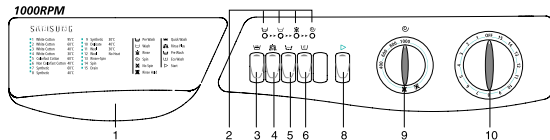

1. Detergent Dispenser

2. Operating Pilot Lights

The pilot lights come on individually, or in groups, according to the program and options selected.

3. Quick Wash Button

This option reduces washing time by using only two rinse cycles.

Use this option for lightly soiled laundry.

Recommended load amount : Up to a maximum of 2 kg.

This function is not available with the wool program.

4. Rinse Plus Button

Selecting this option adds an additional rinse cycle. The washing duration will be prolonged accordingly. This option is recommended for areas with particularly soft water, for baby clothes and to help people with allergies.

This function is not available with the wool program.

5. Prewash Button

Only select for washing heavily soiled laundry. Selecting this option adds a prewash cycle which extends washing time by about 15 minutes. This function is not available with the wool program.

6. Eco Wash Button

Selecting this option increases the washing time and reduces the temperature. This reduces energy consumption without compromising the results of the wash.

The temperature is reduced as shown.

95°C → 60°C, 60°C → 40°C, 40°C → 30°C

The wash time will be slightly longer to compensate for the temperature reduction.

For use when washing normally soiled laundry, to save energy. This function is not available with the wool program.

Washing a Load of Laundry

8. Start Button

This button can be used to both starting or pausing a wash program.

9. Spin Speed Selector Knob

Turn the knob to select the desired spin speed or rinse hold.

SW1050 : 1000, 800, 600, 400, Rinse Hold, No spin

10. Program Selector Knob

Turn the knob to select the desired program. The program is shown as follows

CODE	PROGRAM	TEMP	CODE	PROGRAM	TEMP	CODE	PROGRAM	TEMP
1	White Cotton	95°C	6	Non-Colorfast Cotton	40°C	11	Wool	30°C
2	White Cotton	60°C	7	Synthetic	60°C	12	Wool	-
3	White Cotton	40°C	8	Synthetic	40°C	13	Rinse+Spin	-
4	White Cotton	30°C	9	Synthetic	30°C	14	Spin	-
5	Colorfast Cotton	60°C	10	Delicate	40°C	15	Drain	-

Washing for the first time

Before washing clothes for the first time, you must run a complete cycle without clothes. To do this:

1. Turn the Program Selector Knob to the "3" position.
2. Pour a little detergent into compartment ① in the detergent drawer.
3. Turn on the water supply to the washing machine.
4. Press the Start button.
 - This will remove any water from the manufacturer's test run remaining in the machine.

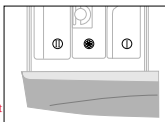

Operating Instruction

1. Open the door and put the laundry (sorted by fabric type) into the drum without overfilling, and close the door.
2. Put the detergent and, if necessary, softener or prewash detergent, in the appropriate compartments.
3. Select the desired program using Program Selector Knob. Turn the Knob in either direction to select fabric type, wash temperature.
4. Turn the Spin Speed Selector Knob to select the desired spin speed or rinse hold.
SW1050 : 1000, 800, 600, 400, Rinse Hold, No spin
5. Select the special option, if required, according to the degree of soil or type of fabric.
The pilot lamp will light up to show that the option is selected.
SW1050 : Quick Wash, Rinse Plus, Prewash, Eco Wash
6. Press the Start button and the wash cycle will begin.

When the cycle is finished

The machine stops automatically. The machine is fitted with a safety device that prevents opening of the door for about 2-3 minutes after the end of program. Open the door and remove the laundry.

Washing a Load of Laundry

Washing tips and hints

Sorting your laundry : Sort your laundry according to the following characteristics:

- **Type of fabric care label symbol :** Sort laundry into cottons, mixed fibers, synthetics, silks, wools and rayon.
- **Colour :** Divide whites and colours. Wash new, coloured items separately.
- **Size:** Placing items of different sizes in the same load will improve the washing action.
- **Sensitivity:** Wash delicate items separately, using the Delicate wash program for pure new wool, curtains and silk articles. Check the labels on the items you are washing or refer to the fabric care chart in the appendix.

Emptying pockets : Coins, safety pins and similar items can damage linen, the washing machine drum, and the water tank.

Securing fasteners : Close zippers and fasten buttons or hooks; loose belts or ribbons should be tied together.

Prewashing cotton : Your new washing machine, combined with modern detergents, will give perfect washing results, thus saving energy, time, water and detergent. However, if your cotton is particularly dirty, use a prewash with a protein-based detergent.

Determining load capacity : Do not overload the washing machine or your laundry may not wash properly. Use the chart below to determine the load capacity for the type of laundry you are washing.

Fabric Type	Load Capacity
Cotton	
-average/lightly soiled	5.0 kg
-heavily soiled	5.0 kg
Synthetics	2.5 kg
Delicates	2.0 kg
Wools	1.5 kg

Detergent tips: The type of detergent you should use is based on the type of fabric (cotton, synthetic, delicate items, wool), colour, wash temperature, degree and type of soiling. Always use "low suds" laundry soap, which is designed for automatic washing machines.

Follow the detergent manufacturer's recommendations based upon the weight of the laundry, the degree of soiling, and the hardness of the water in your area. If you do not know how hard your water is, ask your water authority.

Note:

Keep detergents and additives in a safe, dry place out of the reach of children.

Maintaining the Washing Machine

Draining the washing machine in an emergency

1. Unplug the washing machine from the power supply.
2. Remove the base cover by using a screw driver to pry it off.
3. Unscrew the emergency drain cap by turning left. Grip the cap on the end of the emergency drain tube and slowly pull it out about 20 cm.
4. Allow all the water to flow into a bowl.
5. Reinsert the drain tube and screw the cap back on.
6. Replace the base cover.

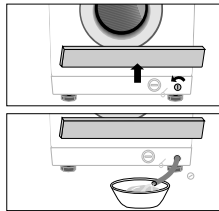

Repairing a frozen washing machine

If the temperature drops below freezing and your washing machine is frozen:

1. Unplug the washing machine.
2. Pour warm water on the source faucet to loosen the water supply hose.
3. Remove the water supply hose and soak it in warm water.
4. Pour warm water into the washing machine drum and let it sit for 10 minutes.
5. Reconnect the water supply hose to the water faucet and check if the water supply and drain operations are normal.

Cleaning the exterior

1. Wipe the washing machine surfaces, including the control panel, with a soft cloth and non-abrasive household detergents.
2. Use a soft cloth to dry the surfaces.
3. Do not pour water on the washing machine.

Cleaning the detergent drawer and recess

1. Press the release lever on the inside of the detergent drawer and pull it out.
2. Remove the cap from compartment ●.
3. Wash all of the parts under running water.
4. Clean the drawer recess with an old toothbrush.
5. Reinsert the cap (pushing it firmly into place) and replace the liquid detergent divider into the drawer.
6. Push the drawer back into place.
7. Run a rinse program without any laundry in the drum.

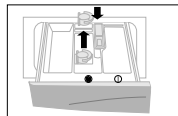

Cleaning the debris filter

Clean the debris filter 2 or 3 times a year.

1. Remove the base cover from the front of the washing machine.
2. Unscrew emergency drain cap by turning left and drain off all the water.
See "Draining the washing machine in an emergency" on page 11.
3. Unscrew the filter cap and take it out.

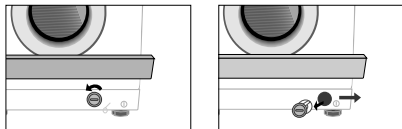

4. Wash any dirt or other material from the filter. Make sure the drain pump propeller behind the filter is not blocked. Replace the filter cap.
5. Replace the base cover.

Cleaning the water hose mesh filter

You should clean the water hose mesh filter **at least one time per year**, or when the lamps on your machine flicker.



To do this:

1. Turn off the water source to the washing machine.
2. Unscrew the hose from the back of the washing machine.
3. With a pair of pliers, gently pull out the mesh filter from the end of the hose and rinse it under water until clean. Also clean the inside and outside of the threaded connector.



4. Push the filter back into place.
5. Screw the hose back onto the washing machine.
6. Turn on the faucet and make sure the connections are watertight.

Problems and solutions

The washing machine will not start

- Make sure the door is firmly closed.
- Make sure the washing machine is plugged in.
- Make sure the water source faucet is turned on.
- Make sure to press the Start button.

No water or insufficient water supply

- Make sure the water source faucet is turned on.
- Make sure the water source hose is not frozen.
- Make sure the water intake hose is not bent.
- Make sure the filter on the water intake hose is not clogged.

Detergent remains in the detergent drawer after the wash program is complete

- Make sure the washing machine is running with sufficient water pressure.
- Put the detergents in the inner parts of the detergent drawer (away from the outside edges).

Washing machine vibrates or is too noisy

- Make sure the washing machine is set on a level surface. If the surface is not level, adjust the washing machine feet to level the appliance (see page 3).
- Make sure that the shipping bolts are removed (see page 3).
- Make sure the washing machine is not touching any other object.
- Make sure the laundry load is balanced.

The washing machine does not drain and/or spin

- Make sure the drain hose is not squashed or bent.
- Make sure the water hose mesh filter is not clogged (see page 12).

Understanding error messages

The appliance is equipped with automatic safety functions able to quickly identify and indicate the presence of faults and react appropriately. Most faults are minor problems that can be solved quickly. Depending on the model you purchased, some lamps in the buttons may flicker. If they do, check the following:

Error displayed

Solution



Close the door.



- Make sure the source water faucet is turned on.
- Check the water pressure.



- Clean the debris filter.
- Make sure the drainage hose is installed correctly.



Laundry load is unbalanced; loosen any tangled laundry.



SW1050

If only one item of clothing needs washing, such as a bathrobe or jeans, the final spin result might be unsatisfactory and an "Unbalancing" error message will be shown in the display window.

Before contacting After-Sales service:

1. Try to remedy the problem (See "Troubleshooting" on this page).
2. Restart the programme to see if the fault is repeated.
3. If the malfunction persists, call after-sales service and **describe the problem**.

Programme Chart

PRO-GRAM	Max load (kg)	DETERGENT AND ADDITIVES			Temperature (MAX) °C	Spin Speed(MAX)rpm	Function	Water (l)	Electricity (kWh)
		Pre wash	wash	Softener					
White Cotton	5.0	*	yes	*	95	1000	*	49	1.82
Colorfast Cotton	5.0	*	yes	*	60	1000	*	49	0.95
Non-Colorfast Cotton	5.0	*	yes	*	40	1000	*	49	0.55
Synthetic	2.5	*	yes	*	60	800	*	50	0.72
Delicate	2.0	*	yes	*	40	600	*	53	0.49
Wool	1.5	-	yes	*	30	400	-	59	0.52
Rinse+Spin	5.0	-	-	*	-	1000	-	38	0.05
Spin	5.0	-	-	-	-	1000	-	-	0.05

PROGRAM	Type of WASH
Cotton	Average or lightly soiled cottons, bed linen, table linen, underwear, towels, shirts, etc.
Synthetic	Average or lightly soiled blouses, shirts, ect which are made of polyester (diolen, trevira), polyamide (perlon, nylon) or other similar blends.
Delicate	Delicate curtains, dresses, skirts, shirts and blouses.
Wool	Only machine washable woolens with pure new wool label.
Quick	Lightly soiled cottons or linen blouses, shirts, dark coloured terry cloth, coloured linen articles, jeans, etc.

1. Programme with prewash lasts approx. 15 minutes longer.
2. The programme duration data has been measured under the conditions specified in Standard IEC 456.
3. Consumption in individual homes may differ from the values given in the table due to variations in the pressure and temperature of the water supply, the load and the type of laundry.

Appendix

Fabric care chart

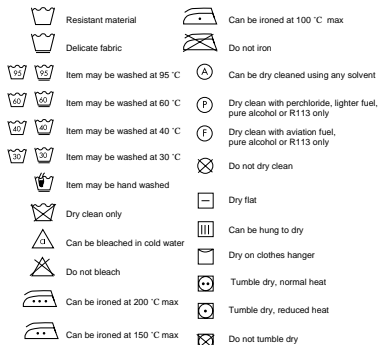

Electrical warnings

To reduce the risk of fire, electrical shock, and other injuries, keep these safety precautions in mind:

- Operate the appliance only from the type of power source indicated on the marking label. If you are not sure of the type of power supplied to your home, consult your appliance dealer or local power company.
- Use only a grounded or polarized outlet. For your safety, this appliance is equipped with a polarized alternating current line plug having one blade wider than the other. This plug will fit into the power outlet only one way. If you are unable to insert the plug fully into the outlet, try reversing the plug. If the plug still doesn't fit, contact your electrician to replace your outlet.
- Protect the power cord. Power supply cords should be routed so that they are unlikely to be walked on or pinched by items placed on or against them. Pay particular attention to cords at plugs, convenience receptacles, and the point where they exit from the unit.
- Do not overload the wall outlet or extension cords. Overloading can result in fire or electric shock.

Protecting the environment

- This appliance is manufactured from recyclable materials. If you decide to dispose of this appliance, please observe local waste disposal regulations. Cut off the power cord so that the appliance cannot be connected to a power source. Remove the door so that animals and small children cannot get trapped inside the appliance.
- Do not exceed the detergent quantities recommended in the detergent manufacturers' instructions.
- Use stain removal products and bleaches before the wash cycle only when strictly necessary.
- Save water and electricity by only washing full loads (the exact amount depends upon the program used).

Declaration of conformity

This appliance complies with European safety standards, EC directive 93/68 and EN Standard 60335.

Specification

TYPE	FRONT LOADING WASHER			
DIMENSION	W598mm × D550mm × H844mm			
WATER PRESSURE	50 kPa ~ 800 kPa			
WEIGHT	75 kg			
WASH and SPIN CAPACITY	5.0 kg (DRY LAUNDRY)			
POWER CONSUMPTION	WASHING	220V	180W	
		240V	180W	
	WASHING AND HEATING	220V	2000W	
		240V	2400W	
	SPIN	MODEL	SW1050	
		220V	500W	
PUMPING	34W			
WATER VOLUME	49 l (STANDARD COURSE)			
SPIN REVOLUTION	MODEL	SW1050		
	rpm	1000		
PACKAGE Wt	PAPER	2.6 kg		
	PLASTIC	0.9 kg		

IN CASE THE NEED FOR
SERVICING ARISES

-Don't hesitate to call any AS center nearby with your name, address and telephone number when anything wrong with your product occurs.



SAMSUNG

ELECTRONICS

Code No.: DC68-00796A-DW
YGL